

**ROTARY LIFT**<sup>®</sup>  
*The World's Most Trusted Lift*<sup>™</sup>



**Two-Post**

*Professional Automotive*



# Features and Benefits



Shown: S15i  
15,000 lbs. capacity  
symmetrical lift with  
*inbay*<sup>®</sup> package



Shown: S10i  
10,000 lbs. capacity  
symmetrical lift with  
*inbay*<sup>®</sup> package



## Engineered for Productivity

For decades, Rotary<sup>®</sup> has been the recognized leader in vehicle service lifts. This legendary reputation has set the standard for quality, durability, reliability and attention to safety throughout the automotive service market.

## Service and Support

With Rotary lifts, you have the service and support you need. Our world-wide network of service companies are always standing by.

## Lift Safety Standards

Most of our lifts are third party tested by ETL and certified by ALI to meet or exceed strict ANSI standards such as cable cut and deformation tests.

Be sure the lift you buy has the gold ALI/ETL label that assures your lift has been tested to meet these standards.

## Key Productivity Features

Dual controls with 110V electric and air outlets right on the lift make this two-post lift the ultimate choice for productivity seeking technicians and managers.



## Higher Capacity!

10,000 lbs. capacity is standard on asymmetrical and symmetrical lifts!

## Dual Controls!

*inbay* lifts have operation controls on each column

Shown: A10i



10,000 lbs. capacity  
shown with *inbay*,  
additional equipment and accessories

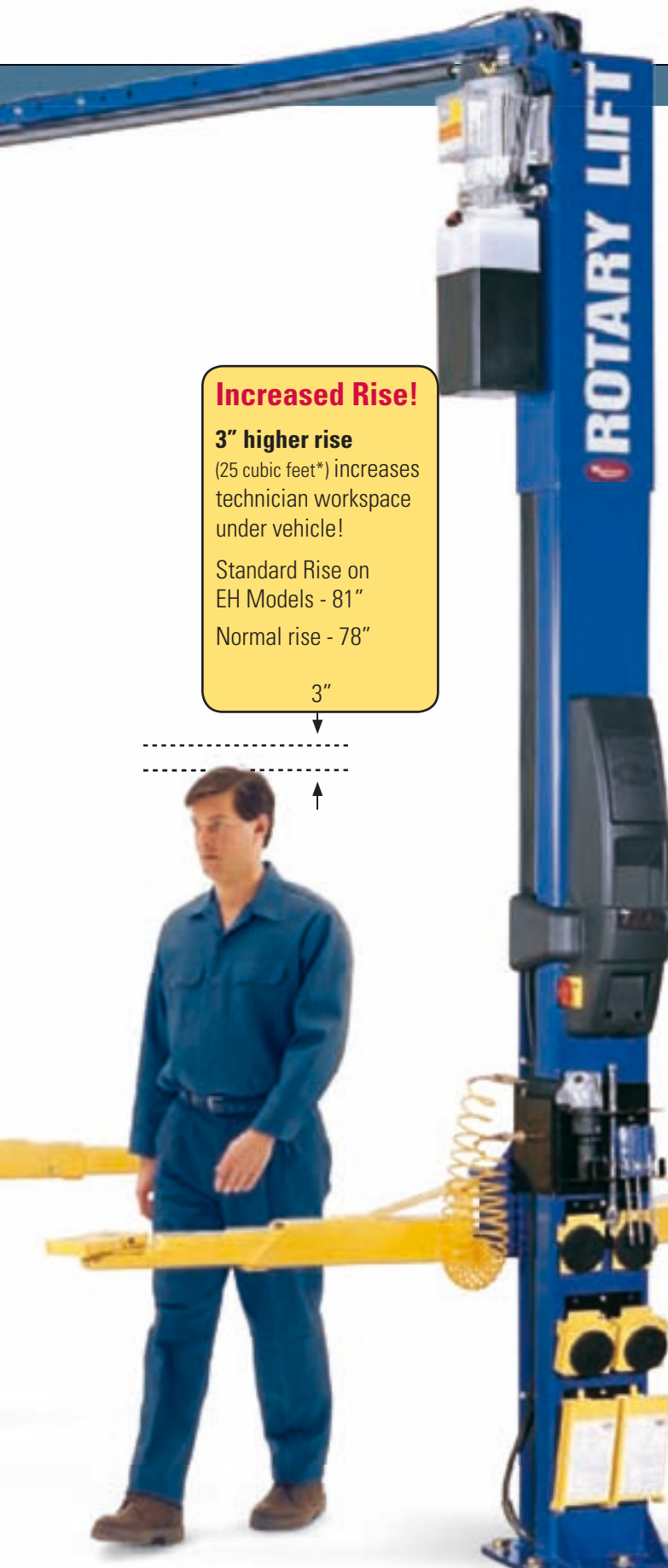

**Increased Rise!**  
**3" higher rise**  
 (25 cubic feet\*) increases technician workspace under vehicle!  
 Standard Rise on EH Models - 81"  
 Normal rise - 78"  
 3"

**Technician Productivity Features**

- Unlike most other lifts, Rotary® power units are designed and built by Rotary, for Rotary lifts. We don't use 3<sup>rd</sup> party power units which are for universal applications.
- Adjustable height option on two-post column extensions gives you flexibility during installation to maximize the vehicles you can service with each lift.
- The patented "Double S" (US Patent No. 5,009,287) single piece construction column design provides a channel for the bearings to travel that maximizes the strength of the column and surface contact area of the bearing.
- Slider block bearings of Tivar® 1000 polyethylene are self-lubricating and maintenance free.
- High-pressure cylinders in each column provide maximum lifting force and smooth operation.
- Arm restraints make positioning of arms easy. They engage when the lift is raised and automatically disengage when the lift is fully lowered.
- Overhead padded switch bar to prevent damaging a vehicle from being raised too high.
- Standard three-position flip-up adapters allow for quick and easy contact with pickup points on a variety of vehicles. We offer the highest standard adapter reach in the industry, often avoiding the need for additional adapters. Low profile arm design on all 10,000 lbs. capacity models (4 3/4" from floor to flip-up adapter min. height) accommodate more vehicles.

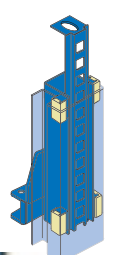

**Three-Stage/Front and Two-Stage/Rear arms:**

The three-stage arm increases overall arm sweep and minimum arm reach to precisely lift vehicles that have:

- Uni-body construction\*\*
- Visually marked pick-up points on the vehicle
- Wider vehicle treadwidth and lower profile
- A short or long wheelbase

\* 25 cubic feet is based on an average sedan raised 3" higher than standard lift.

\*\* To lift trucks and other frame type vehicles Rotary recommends using the FJ6182 adapter. Kit FJ6197



# Two-Post Configurations

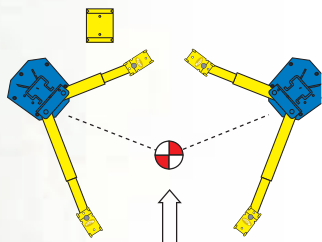

Asymmetrical column orientation

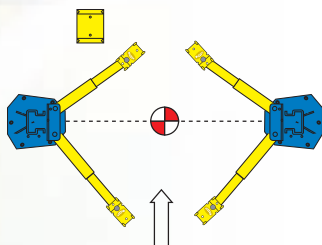

Symmetrical column orientation

## Lift Column Orientation Options

### True Asymmetrical Lifts

(SPOA/A series)

- Columns are rotated 30°
- Places the approximate center of gravity of the vehicle in line with the optimum load capability of the column
- Allows maximum door opening on passenger cars for improved access to vehicle interior and under the dash
- Lift capacities 7,000 to 10,000 lbs. with extended heights (EH) and low ceiling (LC) options available

### True Symmetrical Lifts

(SPO/S series)

- Columns are not rotated
- Vehicle load is centered between the columns to maximize lifting capacity
- Lift capacities 10,000 to 18,000 lbs. with extended height (EH) and low ceiling (LC) options available
- More width between columns to accommodate larger vehicles and improve vehicle access

## Vehicle Contact Configurations



Three-position flip-up adapters are great for quick positioning on a variety of pick-up points. Auxiliary adapters are available.



**NEW** polymer RA adapters that screw-up or have optional stackable inserts. No metal to metal.



Fixed pad contact lifts (P) are perfect for quick vehicle spotting and can increase vehicle throughput. This is the perfect lift for a quick-lube bay.



Stackable adapters are specifically designed for easy use. Standard on 12,000 - 18,000 lbs. capacity lifts.

## Overhead Heights and Lift Width Configurations



Extended height (EH) options are available to maximize the working height under tall vehicles.

EH models come with a standard rise of 81".

Low-ceiling (LC) lifts are also available for shops with ceilings as low as 10'.

RA models accommodate narrow bays by adjusting the columns in 6".

## Operating Controls and Power Unit Configurations



### Conventional

#### Features

- Conventional two-hand operation
- Power unit down
- Manual two-handed release locking system



### inbay®

#### Features

- One touch controls on each column
- Power unit up and out of the way
- Integrated air/electric connections
- Tool storage rack
- Electronic locks

## Dual Controls



OSHA compliant lockable disconnect switch is standard on inbay models. This feature avoids the need to pay extra for a lockable disconnect required to meet local electric codes.

Increase the speed of your lift with an optional 3-phase power unit.

## Arm Configurations for Frame Engaging Lifts

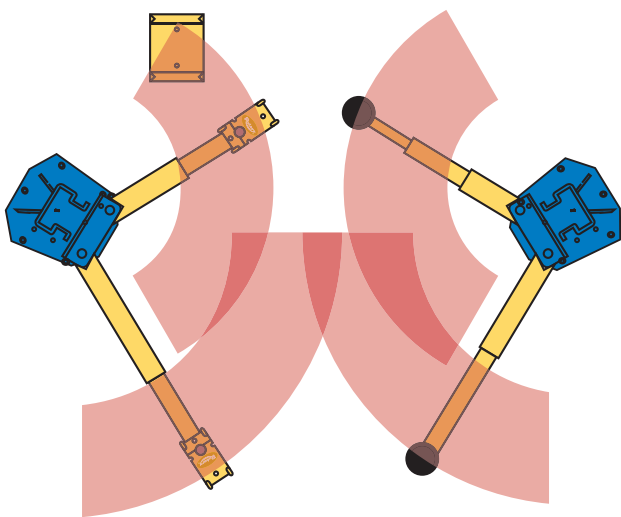

Shown arm configurations are available on asymmetric 10,000 lbs. capacity models only.

### Two-Stage arms:

Standard configuration designed to accommodate a wide range of typical vehicles with three-position adapters.

### Three-Stage/Front and Two-Stage/Rear arms:

The three-stage arm increases overall arm sweep and minimum arm reach to precisely lift vehicles that have:

- Uni-body construction\*
- Visually marked pick-up points on the vehicle
- Wider vehicle treadwidth and lower profile
- A short or long wheelbase



\* To lift trucks and other frame type vehicles Rotary recommends using the FJ6182 adapter. Kit FJ6197



## Specifications

### Identifying Model Numbers

Lift Type	Lift Capacity (x 1000)	Lift Application/Adapters	Package Name	Overhead Height
SPO	10	RA		EH2
A	7	P	i	

#### Examples:

SPO10-RA-EH2 = Conventional Symmetrical 10,000 lbs. capacity lift with screw-up adapters and extended height of 2'.

A7Pi = Asymmetrical 7,000 lbs. capacity lift with fixed pads, inbay package and standard height.

#### Lift Types:

SPOA.....Conventional asymmetrical lift  
 SPO.....Conventional symmetrical lift  
 A.....Asymmetrical lift  
 S.....Symmetrical lift

#### Lift Applications and Adapter Options:

LC.....Low-ceiling application  
 P.....Fixed pad lift  
 82.....Fixed pad lift  
 RA.....Thread-up pad adapters

#### Package Names:

i.....inbay

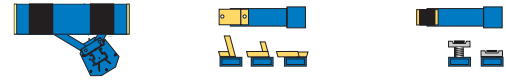

#### Overhead Height:

EH1.....Extended height 1'  
 EH2.....Extended height 2'  
 EH4.....Extended height 4'



Model:	SPOA82 A7Pi	SPOA7LC	SPOA7LC-RA
A. Rise*	74" (1880mm) 77" (1956mm)	78" (1981mm)	74" (1880mm)
B. Height Overall: Standard	11' 8" (3556mm)	9' 11 1/2" (3035mm)	9' 11 1/2" (3035mm)
EH1	12' 8" (3861mm)	10' 11 1/2" (3264mm)	10' 11 1/2" (3264mm)
EH2	13' 8" (4166mm)	N/A	N/A
EH4	N/A	N/A	N/A
C. Width Overall** (outside of base plate)	10' 11 3/8" (3337mm)	10' 11 3/8" (3337mm)	10' 11 3/8" (3337mm)
D. Drive-Thru Clearance	89" (2261mm)	89" (2261mm)	89" (2261mm)
E. Floor To Overhead Switch	11' 4" (3455mm)	9' 6" (2896mm)	9' 6" (2896mm)
F. Reach (front arm min.)	N/A	21 5/8" (548mm)	22 1/2" (570mm)
G. Reach (front arm max.)	N/A	37" (938mm)	32 3/4" (830mm)
H. Reach (rear arm min.)	N/A	35 1/2" (902mm)	36 3/8" (924mm)
I. Reach (rear arm max.)	N/A	57 1/4" (1453mm)	53" (1345mm)
J. Min. Adapter Height	N/A	4" (102mm)	4 3/8" (111mm)
K. Low Step Height	N/A	6 1/8" (156mm)	N/A
L. High Step Height	N/A	10" (254mm)	6" (152mm)
M. Inside Columns	100 1/4" (2546mm)	100 1/4" (2546mm)	100 1/4" (2546mm)
N. Cylinder Height (full rise)*	11' 11" (3632mm) 12' 5" (3785mm)	N/A	N/A
Lifting Capacity	7,000 lbs. (3175kg)	7,000 lbs. (3175kg)	7,000 lbs. (3175kg)
Motor	2 HP	2 HP	2 HP
Voltage Single Phase †	208v-230v	208v-230v	208v-230v
Time of Full Rise	45 seconds	45 seconds	45 seconds
Ceiling Height Required:			
Standard	12' (3658mm)	10' (3048mm)	10' (3048mm)
EH1	12' 9" (3886mm)	10' 9" (3277mm)	10' 9" (3277mm)
EH2	13' 9" (4191mm)	N/A	N/A
EH4	N/A	N/A	N/A
Max. Load (per arm)	1,750 lbs. (794kg)	1,750 lbs. (794kg)	1,750 lbs. (794kg)

### Wheel Spotting Dish Application Chart

	Less than 105" wheelbase: spot vehicle behind wheel spotting dish
	105"-127" wheelbase: spot vehicle in wheel spotting dish
	Over 127" wheelbase: spot vehicle in front of wheel spotting dish

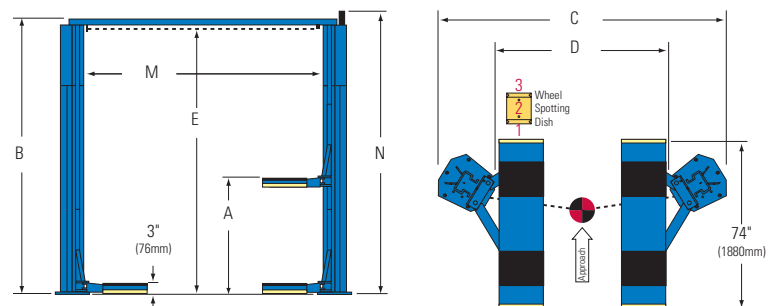

Models: SPOA82  
A7Pi

\* Rise is measured with adapter in highest position. On standard height models, cylinder height is higher than overall height. Second/bottom number is because of extra rise options.

\*\* Overall heights and widths reflect standard settings. Alternate settings may be available, refer to Installation Instruction Manual or consult factory for details.

† Optional 3-phase electrical available. Additional 110v circuit drop required for inbay® lift.

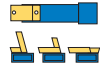

Model:	SPOA10 A10i	SPOA10-RA A10i-RA (3-stage front arm)
A. Rise*	78" (1981mm) 81" (2057mm)	74" (1880mm) 77" (1956mm)
B. Height Overall: Standard	11' 8 1/2" (3569mm)	11' 8 1/2" (3569mm)
EH1	12' 8 1/2" (3873mm)	12' 8 1/2" (3873mm)
EH2	13' 8 1/2" (4178mm)	13' 8 1/2" (4178mm)
EH4	N/A	N/A
C. Width Overall** (outside of base plate)	11' 5 1/2" (3493mm)	11' 5 1/2" (3493mm)
D. Drive-Thru Clearance	95 1/4" (2416mm)	95 1/4" (2416mm)
E. Floor To Overhead Switch	11' 2 3/4" (3423mm)	11' 2 3/4" (3423mm)
F. Reach (front arm min.)	20 1/2" (521mm)	21 5/8" (550mm)
G. Reach (front arm max.)	40 3/4" (1036mm)	43 1/2" (1106mm)
H. Reach (rear arm min.)	40 1/4" (1019mm)	34 1/2" (878mm)
I. Reach (rear arm max.)	61" (1548mm)	58" (1474mm)
J. Min. Adapter Height	4 3/4" (121mm)	3 5/8" (93mm)
K. Low Step Height	7" (178mm)	N/A
L. High Step Height	10 1/4" (260mm)	5 7/8" (149mm)
M. Inside Columns	107 1/4" (2727mm)	107 1/4" (2727mm)
N. Cylinder Height (full rise)*	11' 10 3/4" (3626mm) 12' 4 3/4" (3778mm)	11' 10 3/4" (3626mm) 12' 4 3/4" (3778mm)
Lifting Capacity	10,000 lbs. (4536kg)	10,000 lbs. (4536kg)
Motor	2HP	2HP
Voltage Single Phase †	208v-230v	208v-230v
Time of Full Rise	45 seconds	45 seconds
Ceiling Height Required:		
Standard	12' (3658mm)	12' (3658mm)
EH1	12' 9" (3886mm)	12' 9" (3886mm)
EH2	13' 9" (4191mm)	13' 9" (4191mm)
EH4	N/A	N/A
Max Load (per arm)	2,500 lbs. (1134kg)	2,500 lbs. (1134kg)

Model:	SP010 S10i
A. Rise*	78" (1981mm) 81" (2057mm)
B. Height Overall: Standard	11' 8 1/2" (3569mm)
EH1	12' 8 1/2" (3873mm)
EH2	13' 8 1/2" (4178mm)
EH4	15' 8 1/2" (4788mm)
C. Width Overall** (outside of base plate)	11' 5 1/2" (3493mm)
D. Drive-Thru Clearance	102 1/2" (2603mm)
E. Floor To Overhead Switch	11' 2 3/4" (3423mm)
F. Reach (front arm min.)	31" (787mm)
G. Reach (front arm max.)	54" (1372mm)
H. Reach (rear arm min.)	31" (787mm)
I. Reach (rear arm max.)	54" (1372mm)
J. Min. Adapter Height	4 3/4" (121mm)
K. Low Step Height	7" (178mm)
L. High Step Height	10 1/4" (260mm)
M. Inside Columns	114 1/2" (2908mm)
N. Cylinder Height (full rise)*	11' 10 3/4" (3626mm) 12' 4 3/4" (3778mm)
Lifting Capacity	10,000 lbs. (4536kg)
Motor	2 HP
Voltage Single Phase †	208v-230v
Time of Full Rise	45 seconds
Ceiling Height Required:	
Standard	12' (3658mm)
EH1	12' 9" (3886mm)
EH2	13' 9" (4191mm)
EH4	15' 9" (4801mm)
Max Load (per arm)	2,500 lbs. (1134kg)

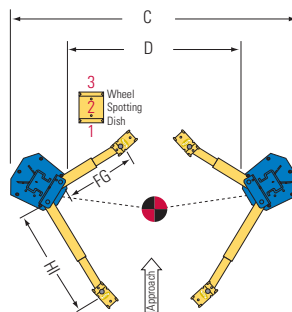
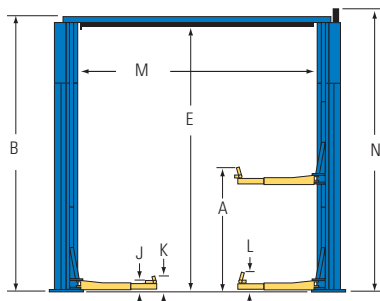

Models: SPOA7LC A7LCi SPOA7LC-RA A7LCi-RA SPOA10 A10i SPOA10-RA A10i-RA

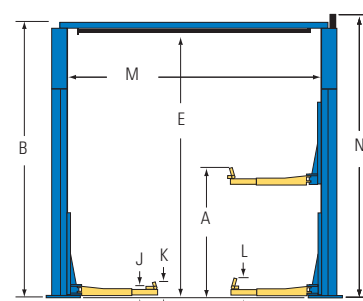

Models: SP010 S10i

Standard color of lifts are blue unless otherwise noted. Red, yellow, gray and black are available at no additional charge. Additional colors are available, consult your Rotary® representative for details.



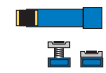

SP010-RA S10i-RA	SP012 S12i	SP015 S15i	SP018 S18i
74" (1880mm) 77" (1956mm)	81 1/16" (2059mm) 84 1/16" (2135mm)	89 1/2" (2273mm)	89 1/2" (2273mm)
11' 8 1/2" (3569mm) 12' 8 1/2" (3873mm) 13' 8 1/2" (4178mm) 15' 8 1/2" (4788mm)	13' 8" (4166mm) 14' 8" (4470mm) 15' 8" (4775mm) N/A	ADJ 15'-16' 6" (4572-5029mm) LC: ADJ 13' 6"-14' 6" (4115-4420mm) N/A	ADJ 15'-16' 6" (4572-5029mm) LC: ADJ 13' 6"-14' 6" (4115-4420mm) N/A
11' 5 1/2" (3493mm)	11' 5 5/8" (3496mm)	12' 11" (3937mm)	12' 11" (3937mm)
102 1/2" (2603mm)	102" (2591mm)	105 3/4" (2686mm)	105 3/4" (2686mm)
11' 2 3/4" (3423mm)	13' 4" (4064mm)	ADJ 14' 5"-15' 11" (4394-4851mm)	ADJ 14' 5"-15' 11" (4394-4851mm)
33 1/8" (841mm)	35" (889mm)	37 1/2" (952mm)	37 1/2" (952mm)
49 5/8" (1261mm)	54" (1372mm)	62" (1574mm)	62" (1574mm)
33 1/8" (841mm)	35" (889mm)	37 1/2" (952mm)	37 1/2" (952mm)
49 5/8" (1261mm)	54" (1372mm)	62" (1574mm)	62" (1574mm)
3 7/8" (92mm)	5 1/16" (129mm)	ADJ 5 3/4"-7 1/2" (146-190mm)	ADJ 5 3/4"-7 1/2" (146-190mm)
N/A	9 1/16" (230mm)	10 3/4" (273mm)	10 3/4" (273mm)
5 7/8" (149mm)	13 1/16" (332mm)	15 3/4" (400mm)	15 3/4" (400mm)
114 1/2" (2908mm)	114 1/2" (2908mm)	120" (3048mm)	120" (3048mm)
11' 10 3/4" (3626mm) 12' 4 3/4" (3778mm)	N/A	N/A	N/A
10,000 lbs. (4536kg)	12,000 lbs. (5443kg)	15,000 lbs. (6804kg)	18,000 lbs. (8165kg)
2 HP	2 HP	2 HP	2 HP
208v-230v	208v-230v	208v-230v	208v-230v
45 seconds	60 seconds	85 seconds	85 seconds
12' (3658mm) 12' 9" (3886mm) 13' 9" (4191mm) 15' 9" (4801mm)	13' 9" (4191mm) 14' 9" (4496mm) 15' 9" (4801mm) N/A	15' 1" min (4597mm) LC: 13' 7" min (4140mm) N/A N/A	15' 1" min (4597mm) LC: 13' 7" min (4140mm) N/A N/A
2,500 lbs. (1134kg)	3,000 lbs. (1360kg)	3,750 lbs. (1700kg)	4,500 lbs. (2041kg)

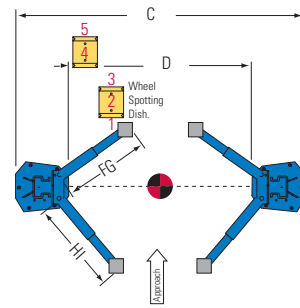
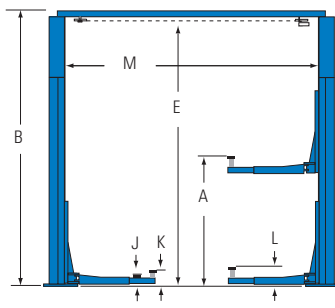
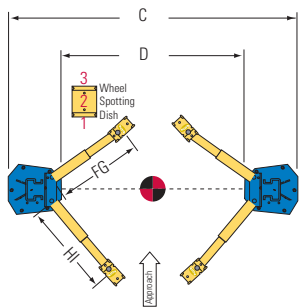

SP010-RA SPO12  
S10i-RA S12i

Models: SP015 SPO18  
S15i S18i

## Two-Post Lifts for Specific Vehicle Applications

Hummer	SPO12-HMR	12,000 lbs. capacity two-post lifts designed to make loading and unloading easier. For Hummer (H1, H2) vehicles with wide track width.
Volkswagen	SPO12 S12i	The 12,000 lbs. capacity two-post lift series was specifically designed to meet all of the Volkswagen vehicle requirements to maximize the use in each lift of their shop. It can accommodate everything from a VW Jetta to the new VW Rialta recreational vehicle.
Honda	A7Pi-HA	Honda Express Service lifts available through the Honda Equipment Program.
Dodge	SPO15-SPRINTER	Specially designed arms for 11,000 lbs. capacity two-post lifts with 3-telescoping stages to meet the pick up point requirements of Sprinter vans.
Mowers and other lawn care equipment	TL07	7,000 lbs. capacity two-post lifts designed to lift turf vehicles for maintenance and repair.
Mercedes	A7i-SLR AR43-3 SL210-RA	Designed to reach visible pick up points on all Mercedes Benz models.



Shown: SPO12-HMR  
12,000 lbs. capacity



Shown: SPO12  
12,000 lbs. capacity



Shown: A7Pi-HA  
7,000 lbs. capacity



Shown: TL07  
7,000 lbs. capacity



Shown: A7i-SLR  
7,000 lbs. capacity



Shown: Three-stage arms and adapters for SPO15-SPRINTER, 11,000 lbs. capacity





Rotary Lift® is the world leader in service bay productivity. We offer a broad range of solutions to make any service bay more productive.

For more information and a complete guide to our product offering, visit us on the web at [rotarylif.com](http://rotarylif.com) or contact your local distributor today.



**AVAILABLE FROM:**

Airdraulics (QLD) Pty Ltd

68 Boyland Avenue  
Coopers Plains 4108

Tel 07 3275 3333

Fax 07 3275 2699

Email [info@airdraulics.com.au](mailto:info@airdraulics.com.au)

[www.airdraulics.com.au](http://www.airdraulics.com.au)

**ROTARY LIFT®**  
*The World's Most Trusted Lift*



A DOVER™ COMPANY

**Rotary World Headquarters North America Contact Information**

2700 Lanier Drive  
Madison, IN 47250, USA  
[www.rotarylif.com](http://www.rotarylif.com)

Sales: p 800.640.5438  
f 800.578.5438  
e [userlink@rotarylif.com](mailto:userlink@rotarylif.com)  
Tech. Support: p 800.445.5438  
f 800.578.5438  
e [userlink@rotarylif.com](mailto:userlink@rotarylif.com)



Lit# PAS\_two-post\_2007.02  
©2006 Rotary®, Printed in U.S.A., All Rights Reserved. Unless otherwise indicated, ROTARY, DOVER and all other trademarks are property of Dover Corporation and its affiliates.